

Double-Ended Cordsets
BCC C3B4-C3B4-30-304-YX84A5-200-C009
Order Code: BCC0JTY

BALLUFF

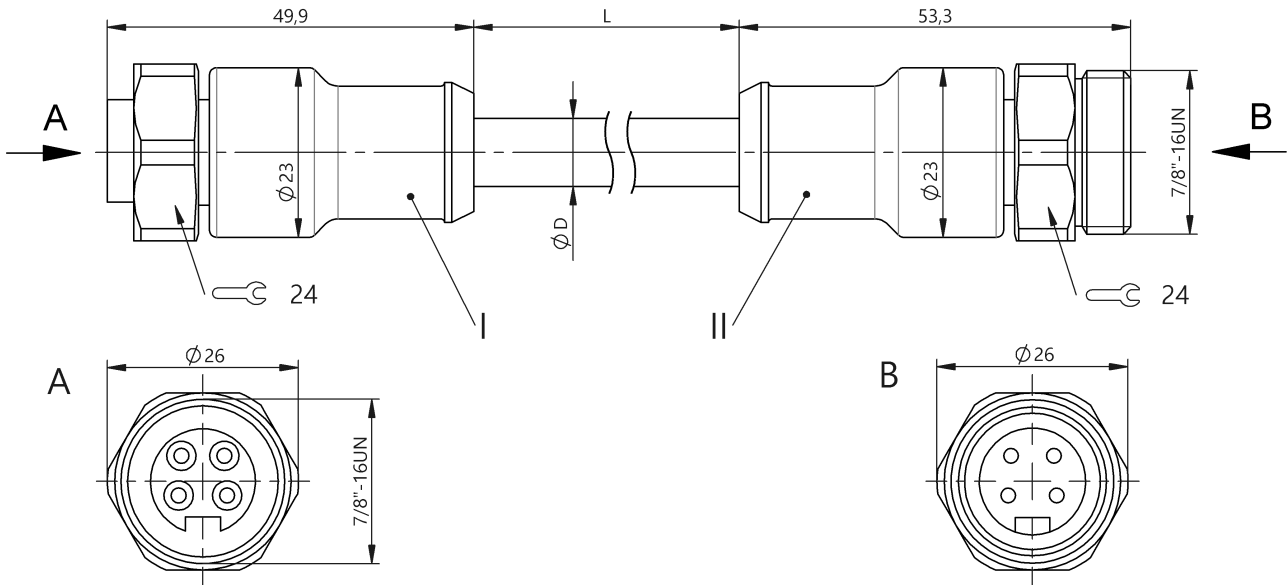

Basic features

| | |
|---------------------|----------------------|
| Approval/Conformity | CE Ecolab WEEE |
|---------------------|----------------------|

Electrical connection

| | |
|-------------------------------------|------------------------------|
| Bending radius min., fixed cable | 5 x D |
| Bending radius min., flexible cable | 10 x D |
| Cable | TPE-V gray, 20 m |
| Cable diameter D | 8.50 mm ±0.3 mm |
| Conductor cross-section | 1.5 mm ² |
| Connection 1 | 7/8"-Female, straight, 4-pin |
| Connection 2 | 7/8"-Male, straight, 4-pin |
| Number of conductors | 4 |
| System | Molded/Molded |

Electrical data

| | |
|--------------------------------------|---------------------|
| Cable rated voltage AC max. | 600 V |
| Cable rated voltage DC max. | 600 V |
| Operating voltage Ub | 300 VDC / 300 VAC |
| Operating voltage Ub 3-phase network | 277/480V AC +/- 15% |
| Rated current (40 °C) | 10.0 A |

Remarks

Halogen-free per DIN VDE 0472 Part 815
 Halogen-free acc. to IEC 60754-1
 LABS-free
 Enclosure rating per IEC 60529 or 20653, only in screwed state with the associated mating piece.

Environmental conditions

| | |
|-------------------------------------|--------------|
| Cable temperature, fixed routing | -50...105 °C |
| Cable temperature, flexible routing | -25...105 °C |
| IP rating | IP69K/IP69K |

Material

| | |
|--------------------------|---|
| Cable jacket, material | TPE-V |
| Material contact carrier | PP/PP |
| Material contacts | Brass/Brass |
| Material cover nut | 1.4404 stainless steel/1.4404 stainless steel |
| Material grip | PP/PP |

Mechanical data

| | |
|---------------------------|---------------|
| Cable jacket, color | gray |
| Cable length L | 20.00 m |
| Tightening torque pigtail | 1.5 Nm/1.5 Nm |

Connector Drawings

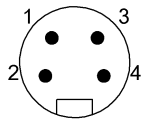

II

PIN 1: brown
PIN 2: white
PIN 3: blue
PIN 4: black

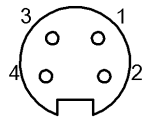

I

PIN 1: brown
PIN 2: white
PIN 3: blue
PIN 4: black

Wiring Diagrams

